

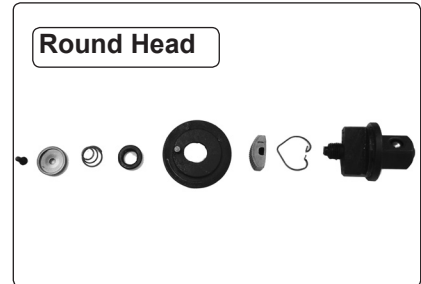

INSTRUCTIONS FOR:

## RATCHET REPAIR KITS

The Sealey Ratchet Repair Kit that has been supplied to you will be one of the following three types:

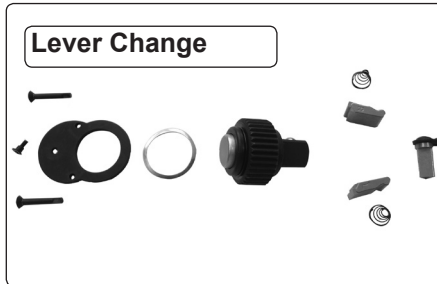
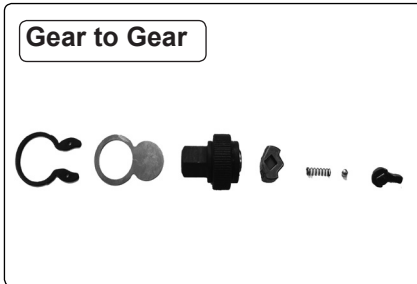

The head can be opened up to access the ratchet mechanism either by releasing the circlip using a pair of internal circlip pliers (fig.1) or removing the securing screws (figs. 2,3 & 4).



This will reveal:

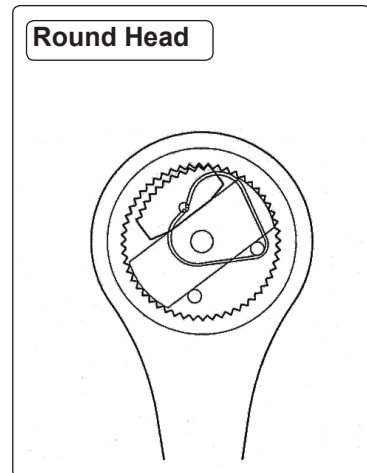
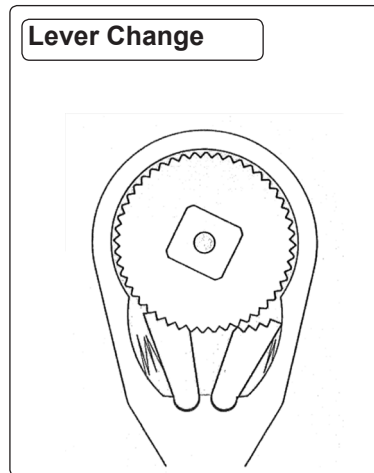
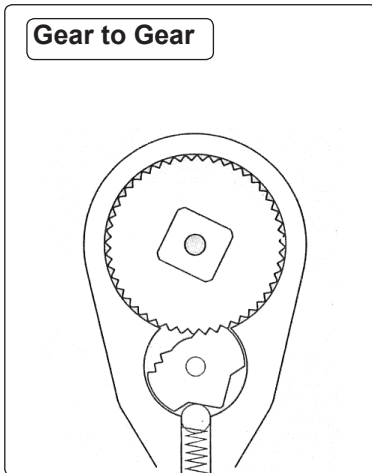

- Remove original components, noting carefully the order in which they were removed.
- Clean inside the ratchet head to remove any dirt or swarf and replace the components with the contents of the repair kit, ensuring that the original order is repeated.
- Please note that the ratchet pawls in the Lever Change kit are marked 'L' and 'R' and should be replaced in the same position as the originals.
- When rebuilding the Gear to Gear head, it may be useful to employ a pair of tweezers to hold the ball in place between the spring and pawl.
- With all internal components in place apply a small amount of grease, close the head back up and resecure.



**Environmental Protection.**  
Recycle unwanted materials instead of disposing of them as waste. All tools, accessories and packaging should be sorted, taken to a recycling centre and disposed of in a manner which is compatible with the environment.



Sole UK Distributor, Sealey Group,  
Kempson Way, Suffolk Business Park,  
Bury St. Edmunds, Suffolk, IP32 7AR

01284 757500

01284 703534



[www.sealey.co.uk](http://www.sealey.co.uk)



[sales@sealey.co.uk](mailto:sales@sealey.co.uk)